



120V 3000K LED RECESSED LIGHTS
With Easy to Replace LED Module



120V LED RECESSED LIGHTS

4" RECESSED LIGHTS 410D874N



6" RECESSED LIGHTS 410D876N

- **Color Rendering Index of 90 Renders colors of paint and cabinets truer and brighter versus others in the industry**
- **Built in driver for superior dimmability**
- **50,000 hour lifespan**
- **Spring clips for easy installation**
- **Energy Star Rated versus others in the industry**
- **J-box meets cubic capacity requirements for HUD and Modular Housing codes**
- **Approved for 14/2 and 12/2 gauge wire**
- **30% Brighter than other lights in the industry**



4" RECESSED



6" RECESSED

120V LED RECESSED LIGHTS

Model	410D874N	410D876N
Height	3.86 Inches	3.31 Inches
Width	5.04 Inches	7.32 Inches
Rough Opening	4.375 Inches	6.5 Inches
Finish	White	White
Voltage	120V AC	120V AC
Frequency	60Hz	60Hz
Power	10W	15W
Dimmable	Yes	Yes
CRI	>90	>90
Lumens	820 lms	1250 lms
Color	3000k	3000k
Power Factor	>0.9	>0.9
Beam Angle	91.2°	99°
Life Time	50,000 hours	50,000 hours
IC Rated	Yes	Yes

4" DIMENSIONAL DIAGRAM

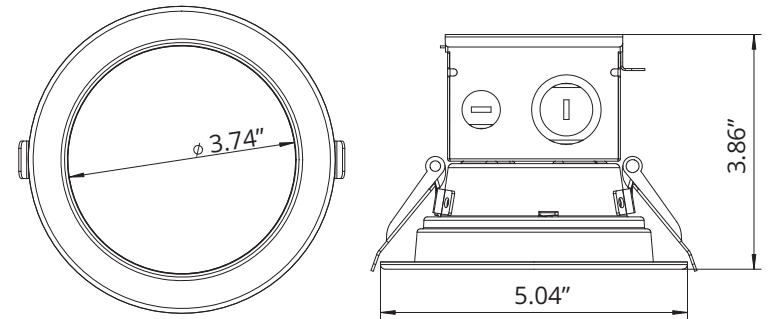

6" DIMENSIONAL DIAGRAM

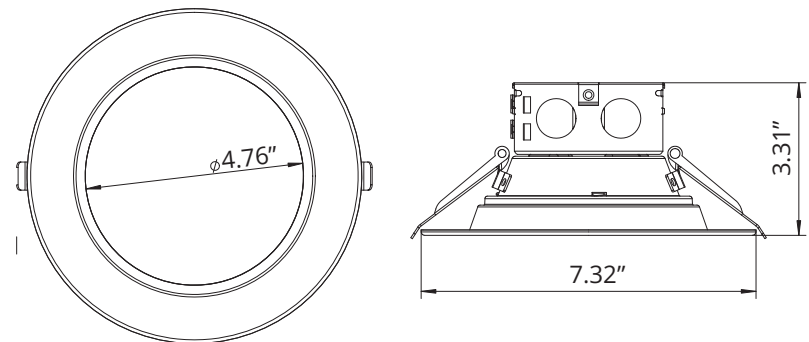

Ratings

- IC
- Air Tight
- Wet Location



4" INSTALLATION INSTRUCTIONS

410D874N

Please read carefully and save these instructions, as you may need them at a later date.

1. **INSTALLATION OR ASSEMBLY INSTRUCTIONS**
Wiring instructions that specify the proper method of connecting the grounding means and maintaining polarity shall be included with the luminaire in a manner that will require the installer to handle the instructions during installation.
2. **THIS PRODUCT MUST BE INSTALLED IN ACCORDANCE WITH THE APPLICABLE INSTALLATION CODE BY A PERSON FAMILIAR WITH THE CONSTRUCTION AND OPERATION OF THE PRODUCT AND THE HAZARDS INVOLVED.**
3. **CONSULT A QUALIFIED ELECTRICIAN TO ENSURE CORRECT BRANCH CIRCUIT CONDUCTOR.**

WARNING- RISK OF FIRE OR ELECTRIC SHOCK

- DO NOT MAKE OR ALTER ANY OPEN HOLES IN AN ENCLOSURE OF WIRING OR ELECTRICAL COMPONENTS DURING LAMP INSTALLATION.
- TO PREVENT WIRING DAMAGE OR ABRASION, DO NOT EXPOSE WIRING TO EDGES OF SHEET METAL OR OTHER SHARP OBJECTS.
- SUITABLE FOR DRY, DAMP OR WET LOCATIONS
- SUITABLE FOR BOTH TYPE IC AND SUITABLE FOR TYPE NON-IC.
- THIS DEVICE IS NOT INTENDED FOR USE WITH EMERGENCY EXITS.



4" INSTALLATION INSTRUCTIONS

410D874N

ASSEMBLY AND INSTALLATION

- This IC/AT fixture is intended for use in recessed cavities or suspended ceilings (with or without insulation). Choose the location for the fixture, taking into consideration the location of the joists, the 5-6 inch depth clearance and electrical supply.

- Shut off electricity at the circuit breaker.

- Cut to 4 ½ in. hole in the ceiling. (FIG1)

- Open the Junction Box Cover.(FIG2)

- Using a screwdriver, remove ¾ inch round knockout or the 3/8 inch rectangle knockout.

- Using the quick connectors in the Junction box, insert the wires AS FOLLOWS:

- WHITE WIRE IN SUPPLY WIRE TO WHITE WIRE IN QUICK CONNECTOR (NEUTRAL)

- BLACK WIRE IN SUPPLY WIRE TO BLACK WIRE IN QUICK CONNECTOR (HOT/LIVE)

- GREEN / BARE WIRE IN SUPPLY WIRE TO GREEN WIRE IN QUICK CONNECTOR (GROUND)

- Carefully push all wires/connectors back into the junction box.
- Snap the cover back to the junction box. (FIG4-1, FIG4-2, FIG4-3)
- Press the top portion of the spring clips against the side of the Housing Assembly. (FIG5)
- Push the Housing Assembly with the top side of the Remodel Clips through the hole until tight. Continue to push the Housing Assembly until the fixture snaps into place with the trim tight against the ceiling. (FIG6)

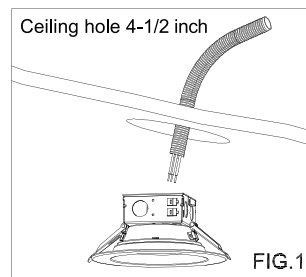

FIG.1

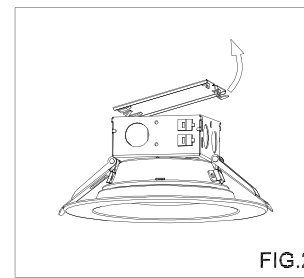

FIG.2

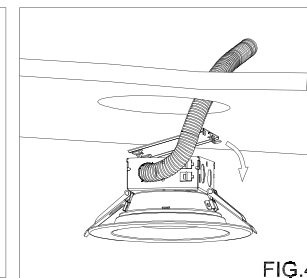

FIG.4

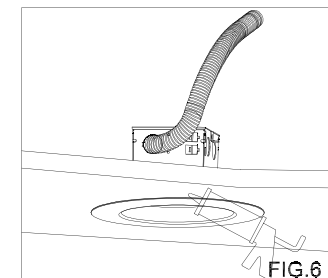

FIG.6

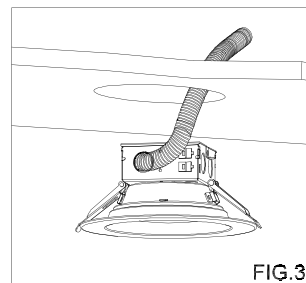

FIG.3

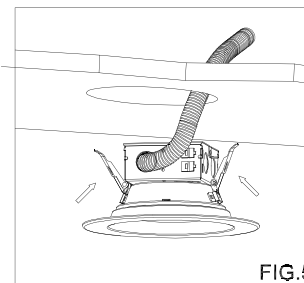

FIG.5

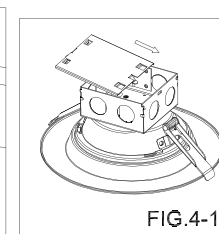

FIG.4-1

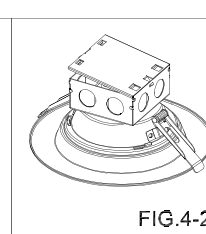

FIG.4-2

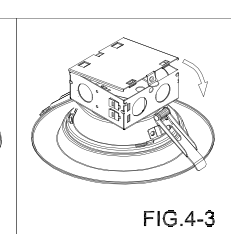

FIG.4-3



4" INSTALLATION INSTRUCTIONS

410D874N

DIMMING

Compatible with the following dimmers:

Lutron: S-603P,S-600P,4X603,DV-

CL-163P-WH,CT-

CL-153PDH-WH,SLV-600P-WH,NT-1000,DV-600

P,S-600PR-WH

Leviton: 6674,IPL06,6683,6672

Dimming performance may depend on the dimmer, the dimmer range adjustment setting (for dimmers with brightness range adjustments), the wiring method, and/or the number of LED modules installed onto the dimmer circuit.

- For dimmer selection, Dimming control manufacturers revise their product often; for the latest list of compatible dimmers please visit our website.
- For best results, it is recommended to install a minimum of four LED modules onto one dimmer.
- Before turning on the LED lights, set dimmer position at maximum before adjusting to a lower light level.
- Please follow the dimming control manufacturer's instructions for the installation of all dimming controls.



6" INSTALLATION INSTRUCTIONS

410D876N

Please read carefully and save these instructions, as you may need them at a later date.

1. **INSTALLATION OR ASSEMBLY INSTRUCTIONS**
Wiring instructions that specify the proper method of connecting the grounding means and maintaining polarity shall be included with the luminaire in a manner that will require the installer to handle the instructions during installation.
2. **THIS PRODUCT MUST BE INSTALLED IN ACCORDANCE WITH THE APPLICABLE INSTALLATION CODE BY A PERSON FAMILIAR WITH THE CONSTRUCTION AND OPERATION OF THE PRODUCT AND THE HAZARDS INVOLVED.**
3. **CONSULT A QUALIFIED ELECTRICIAN TO ENSURE CORRECT BRANCH CIRCUIT CONDUCTOR.**

WARNING- RISK OF FIRE OR ELECTRIC SHOCK

- DO NOT MAKE OR ALTER ANY OPEN HOLES IN AN ENCLOSURE OF WIRING OR ELECTRICAL COMPONENTS DURING LAMP INSTALLATION.
- TO PREVENT WIRING DAMAGE OR ABRASION, DO NOT EXPOSE WIRING TO EDGES OF SHEET METAL OR OTHER SHARP OBJECTS.
- SUITABLE FOR DRY, DAMP OR WET LOCATIONS
- SUITABLE FOR BOTH TYPE IC AND SUITABLE FOR TYPE NON-IC.
- THIS DEVICE IS NOT INTENDED FOR USE WITH EMERGENCY EXITS.



6" INSTALLATION INSTRUCTIONS

410D876N

ASSEMBLY AND INSTALLATION

This IC/AT fixture is intended for use in recessed cavities or suspended ceilings (with or without insulation). Choose the location for the fixture, taking into consideration the location of the joists, the 5-6 inch depth clearance and electrical supply.

- Shut off electricity at the circuit breaker.

- Cut to 6 ½ in. hole in the ceiling. (FIG1)

- Open the Junction Box Cover.(FIG2)

- Using a screwdriver, remove ¾ inch round knockout or the 3/8 inch rectangle knockout.

- Using the quick connectors in the Junction box, insert the wires AS FOLLOWS:

- WHITE WIRE IN SUPPLY WIRE TO WHITE WIRE IN QUICK CONNECTOR (NEUTRAL)

- BLACK WIRE IN SUPPLY WIRE TO BLACK WIRE IN QUICK CONNECTOR (HOT/LIVE)

- GREEN / BARE WIRE IN SUPPLY WIRE TO GREEN WIRE IN QUICK CONNECTOR (GROUND)
- Carefully push all wires/connectors back into the junction box.
- Snap the cover back to the junction box. (FIG4-1, FIG4-2, FIG4-3)
- Press the top portion of the spring clips against the side of the Housing Assembly. (FIG5)
- Push the Housing Assembly with the top side of the Remodel Clips through the hole until tight. Continue to push the Housing Assembly until the fixture snaps into place with the trim tight against the ceiling. (FIG6)

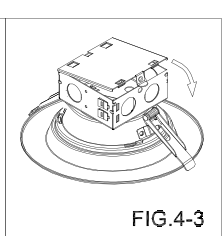
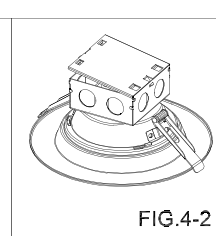
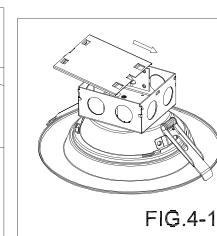
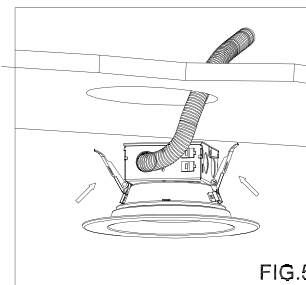
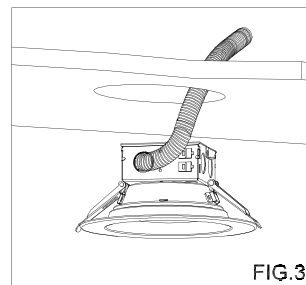
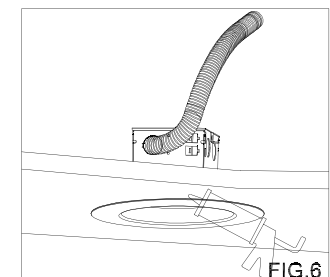
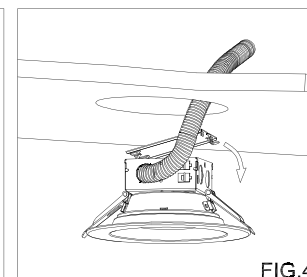
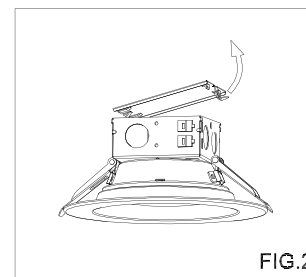
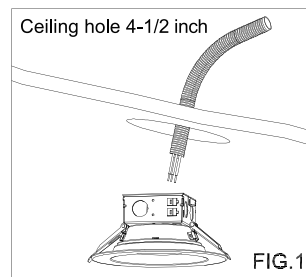



6" INSTALLATION INSTRUCTIONS

410D876N

DIMMING

Compatible with the following dimmers:

Lutron:

S-603P,S-600P,4X603,DVCL-163P-WH,CTCL-153

PDH-WH,SLV-600P-WH,NT-1000,DV-600P,S-60

OPR-WH

Leviton: 6674,IPL06,6683,6672

Dimming performance may depend on the dimmer, the dimmer range adjustment setting (for dimmers with brightness range adjustments), the wiring method, and/or the number of LED modules installed onto the dimmer circuit.

- For dimmer selection, Dimming control manufacturers revise their product often; for the latest list of compatible dimmers please visit our website.
- For best results, it is recommended to install a minimum of four LED modules onto one dimmer.
- Before turning on the LED lights, set dimmer position at maximum before adjusting to a lower light level.
- Please follow the dimming control manufacturer's instructions for the installation of all dimming controls.



120V LED REPLACEMENT MODULES

4" LED MODULE
410RM43K

6" LED MODULE
410RM63K

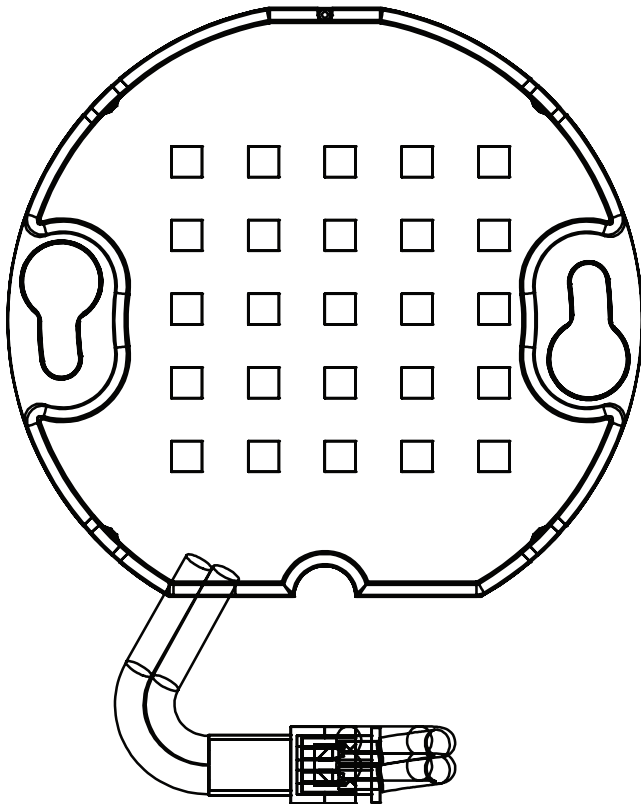

- **High Color Rendering Index renders colors bright and true**
- **Built in driver for superior dimmability**
- **Easy installation as replacement**
- **50,000 hour lifespan**



120V LED RECESSED LIGHTS

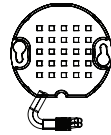

4" MODULE

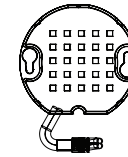

6" MODULE

Model	410RM43K	410RM63K
Height	0.28 Inches	0.28 Inches
Width	2.26 Inches	2.15 Inches
Voltage	120V AC	120V AC
Frequency	60Hz	60Hz
Power	10W	15W
Dimmable	Yes	Yes
CRI	>90	>90
Lumens	820 lms	1250 lms
Color	3,000	3,000
Luminous Flux	>65	>65
Life Time	50,000 hours	50,000 hours
IC Rated	Yes	Yes



Ratings
<ul style="list-style-type: none"> • IC • Air Tight • Wet Location



MODULE REPLACEMENT INFORMATION

While Energy Star rated fixtures are rated for 50,000 hours of useful life under normal working conditions, they can be impacted by power fluctuations. Reordering and replacing LED modules is both safe and easy and can be found in two locations.

Location 1 - Stickers visible upon lens removal

(Provide photo of sticker location)

6" Replacement Module Sticker

To order replacement LED module –
www.recpro.com - Part # 410RM63K

4" Replacement Module Sticker

To order replacement LED module –
www.recpro.com - Part # 410RM63K

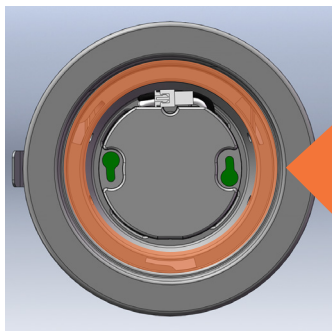

Stickers can be found in the orange area after lens is removed.

Location 2 - Homeowners Packet

Replacing inoperable LED light fixtures in recessed LED Lights

1. Always disconnect power before attempting to evaluate or repair in operable lights.
2. These lights were designed to replace the working LED modules within them.
3. To purchase replacement modules, go to www.recpro.com
 - A. Order the part number on the sticker located on the recessed light housing which can be seen once the lens is removed. (Provide photo of location)
4. The modules are sold in packs of 4
5. See installation instructions on the following page. These will be provided for both the homeowners packets and included within all orders from www.recpro.com.

*** Before starting the process of replacing the module, turn off the electricity to the light at the circuit breaker panel. ***



LED REPLACEABLE MODULE Installation Instructions

STEP 1: Turn the lens counter-clockwise to remove from the light.

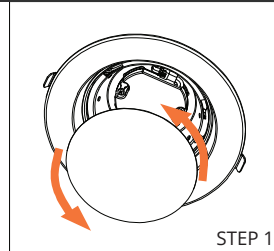

STEP 2: Loosen screws and unplug the module from the light.

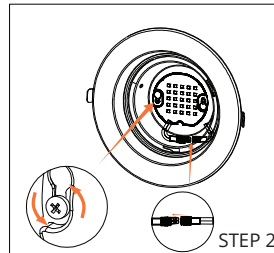

STEP 3: Turn LED module counter-clockwise to remove from screws.

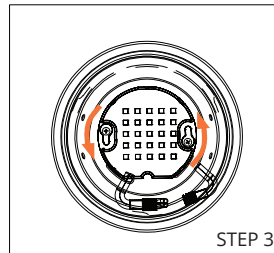

STEP 4: Remove the inoperable LED module.

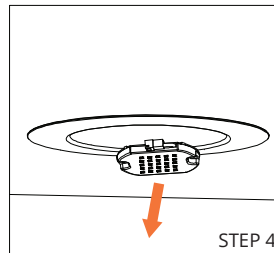

STEP 5: Remove protective film from the thermal conductive silicone pad on the new LED Module.

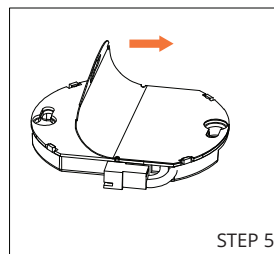

STEP 6: Fit the new LED module over the screw heads attached to the light.

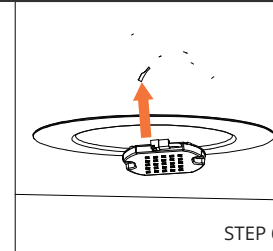

STEP 7: Rotate the module clockwise to lock.

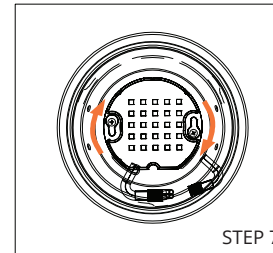

STEP 8: Plug in the wire connector and tighten the screws on the LED module.

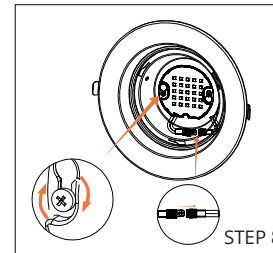

STEP 9: Put the lens back on the light fixture.

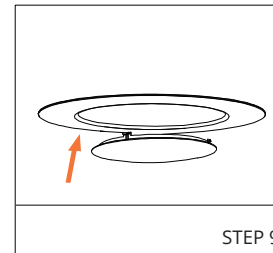

STEP 10: Rotate the lens clockwise to lock it in place. Installation is now complete.

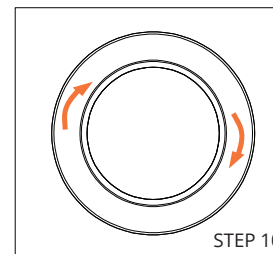



MANUFACTURING WARRANTY

We provide a manufacturing warranty for customers who purchase directly from LaSalle Bristol.

- The warranty applies if any of the following occurs:
 - Product failure with no external factors being the cause (see "Exclusions")
 - Flickering bulb
- Exclusions – This warranty does not cover the following:
 - Improper operation issues including damage caused by unstable current flow.
 - Light is dismantled or modified without approval from LaSalle Bristol.
 - Serial number or production date cannot be obtained by customer.
 - Operation temperature exceeds the range of -4 to 104 degree Fahrenheit.
 - Repair work done by unauthorized personnel without LaSalle Bristol approval.
 - Force Majeure and other Acts of God.
- Warranty period: Three years from the production date shows on indoor bulbs. Five years from date to the warehouse for T8 tubes, downlights, LED street lights, parking lot lights, wall packs, flood lights and canopy lights.